

**Belmont
(Deluxe Studio)**

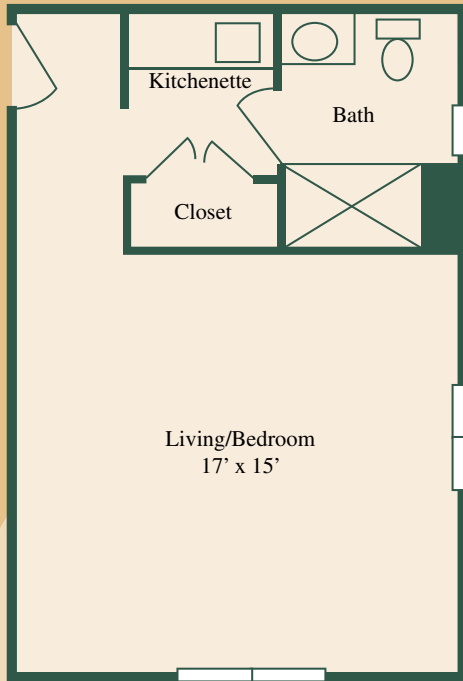

Square Footage: 255 sq.ft.

Living/Bedroom: 17' x 15'

Amenities

HOME

- Emergency Response System
- 24-hour licensed nursing supervision
- Full-time Registered Nurse
- Individual thermostat
- Kitchenette with refrigerator

- Walk-in shower
- Complimentary wireless internet service
- Cable TV available
- All utilities including telephone (long distance not included)

COMMUNITY

- Fine dining directed by our professional chef
- Private dining rooms for special occasions
- Soda Shop
- TV room
- Salon/Barber shop
- Library
- Automatic front doors
- Beautifully landscaped and enclosed courtyard with gazebo
- Social, recreational, educational, and spiritual activities
- Weekly housekeeping and linen service

- Scheduled transportation to doctor appointments
- Planned outings, shopping, and other events
- Wheelchair accessible bus
- Choice of two sunrooms for leisure activities
- State-of-the-art fire safety system with central alarm and complete sprinkler system
- 24-hour security service and a medical alert system
- Priority placement in The Health Center, if needed
- Respite Care